

REVISIONS			
REV	DESCRIPTION	DATE	APPROVED
1	Initial Release Per ECO 16-20909	7/18/16	JAK
2	Changed Pin Side Connector Per ECO 17-22039	1/18/17	JAK
A	Shortened Cable and Release to Prod Per ECO 17-22437	5/18/17	JAK

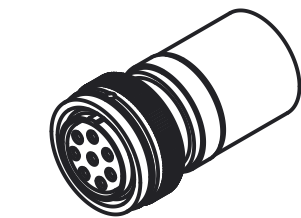

SCALE 0.500

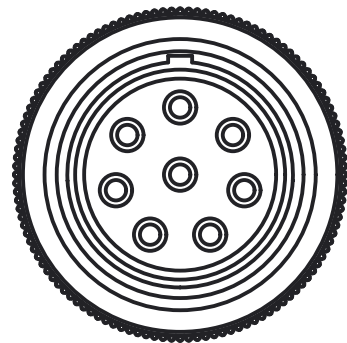

SCALE 0.500

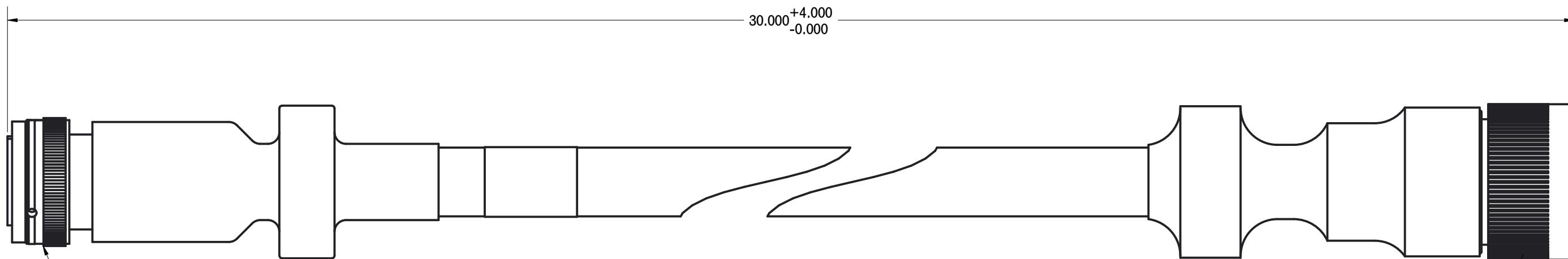
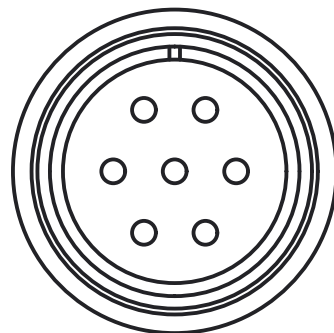

PEI GENESIS: MS3476L18-8S-UHST3

ITT CANNON: CB6UHST-4-24-10PSA34

Notes:

1. REFERENCE SYNQOR SPECIFICATION 705-1000170
2. SOOW WIRE, 12 AWG/ 6 CONDUCTOR (12/6). WIRE INSULATION: COLOR CODED SYNTHETIC RUBBER (EPDM) OIL AND WATER RESISTANT PER UL-62 OVERALL NOMINAL WIRE DIAMETER: .745"
3. WEIGHT: 2.5 lbs

TOLERANCES:

Unless otherwise specified:
All dimensions in inches

- .X +/- .025
- .XX +/- .010
- .XXX +/- .005
- Angles +/- 1°

Third Angle Projection

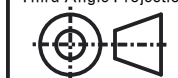

THIS DRAWING IS THE PROPERTY OF SYNQOR LLC.
It is not to be reproduced or copied, in whole or in part, or used for furnishing information to others, or for any purpose detrimental to the interests of SynQor. The information shown herein may be protected by patents owned or controlled by SynQor.



155 Swanson Road
Boxborough, MA 01719-1316

EBM 1500 DC Output External Cable

SOURCE: PRO/E MS3467L14-4PW

SIZE	DATE	DWG. NO.	REV
B	5/18/17	SYN-9183	A
SCALE: 1.000	DRAWN: JAK	CHECK:	SHEET 1 of 1